

D . D . A .

DWARKA PROJECT

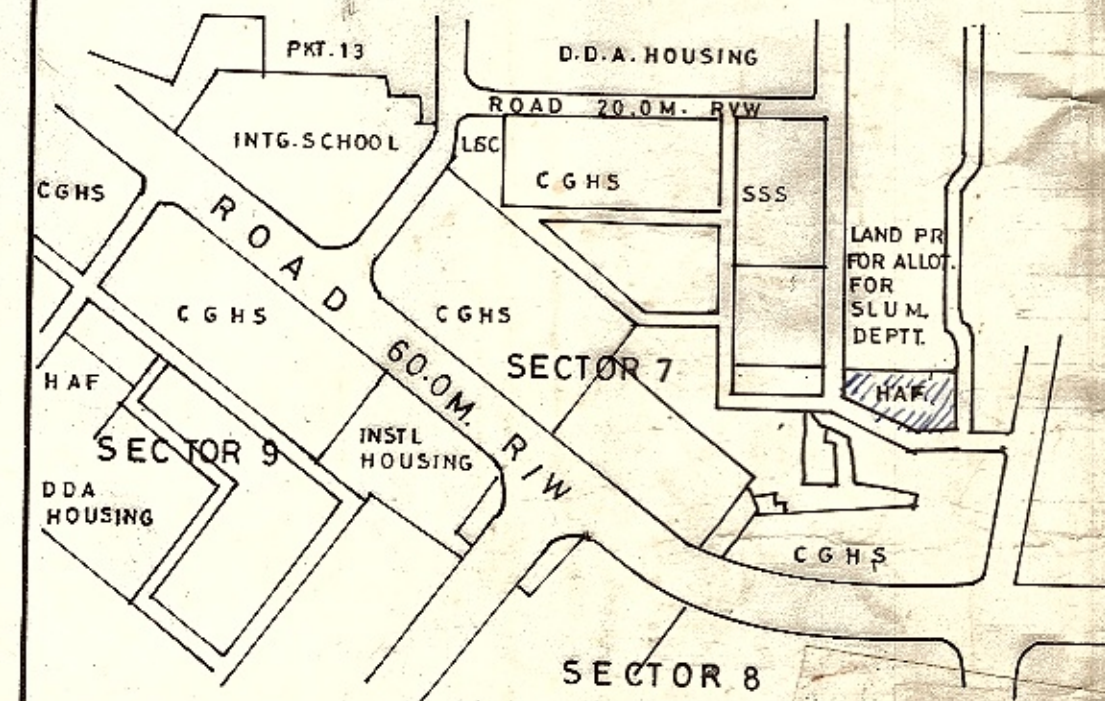

KEY PLAN

AREA STATEMENT

TOTAL AREA OF THE SITE	7570.40 SQ.M.
PRIMARY SCHOOL	4117.54 Sqm.
CONV. SHOPPING.MB.	1334.25 Sqm.
NURSERY SCHOOL	819.86 Sqm.
RELIGIOUS	400.00 Sqm.
COMMUNITY ROOM	760.00 Sqm.
ELECTRIC SUB. STATION	14175 Sqm.

NOTES

1. HEIGHT GR. COVERAGE & F.A.R. IS AS PER M.P.D. 2001.
  2. FOLLOW THE WRITTEN DIMENSION.
- i) THE PLAN IS SUBJECT TO MODIFICATIONS WITHIN THE FRAMEWORK OF MASTER PLAN/ZONAL PLAN.  
 ii) IT IS FOR PLANNING PURPOSE & IS NOT FIT TO BE PRODUCED IN THE COURT OF LAW FOR PROPERTY DISPUTES.  
 iii) ALL THE DIMENSIONS & AREA GIVEN IN THE PLAN ARE SUBJECT TO CONFIRMATION OF OWNERSHIP/ALLOTMENT STATUS AND DEMARCATIONS/FEASIBILITY REPORT FROM THE DDA LANDS & ENGINEERING WING RESPECTIVELY.

- APPROVED BY COMMISSIONER PLG. ON Pg. 20N IN FILE NO: F 8 (10) 94 DWK / HAF-2 / PART-1
- FEASIBILITY INCORPORATED AS PER FEASIBILITY REPORT RECEIVED FROM EE/WD-8/D.D.A VIDE LETTER NO F1(275)AEC/P/WD-8/DDA/196 DATED 9.1.98 IN FILE NO F 8 (40) 98 - DWK / HAF.

HOUSING AREA FACILITY

PKT. 2 SECTOR 7

LAY OUT PLAN



PLG. D MAN	RUPINDER PLG. ASSTT	DATE	
ASSTT. DIRECTOR	JT. DIRECTOR	DIRECTOR PLG. COMM.	

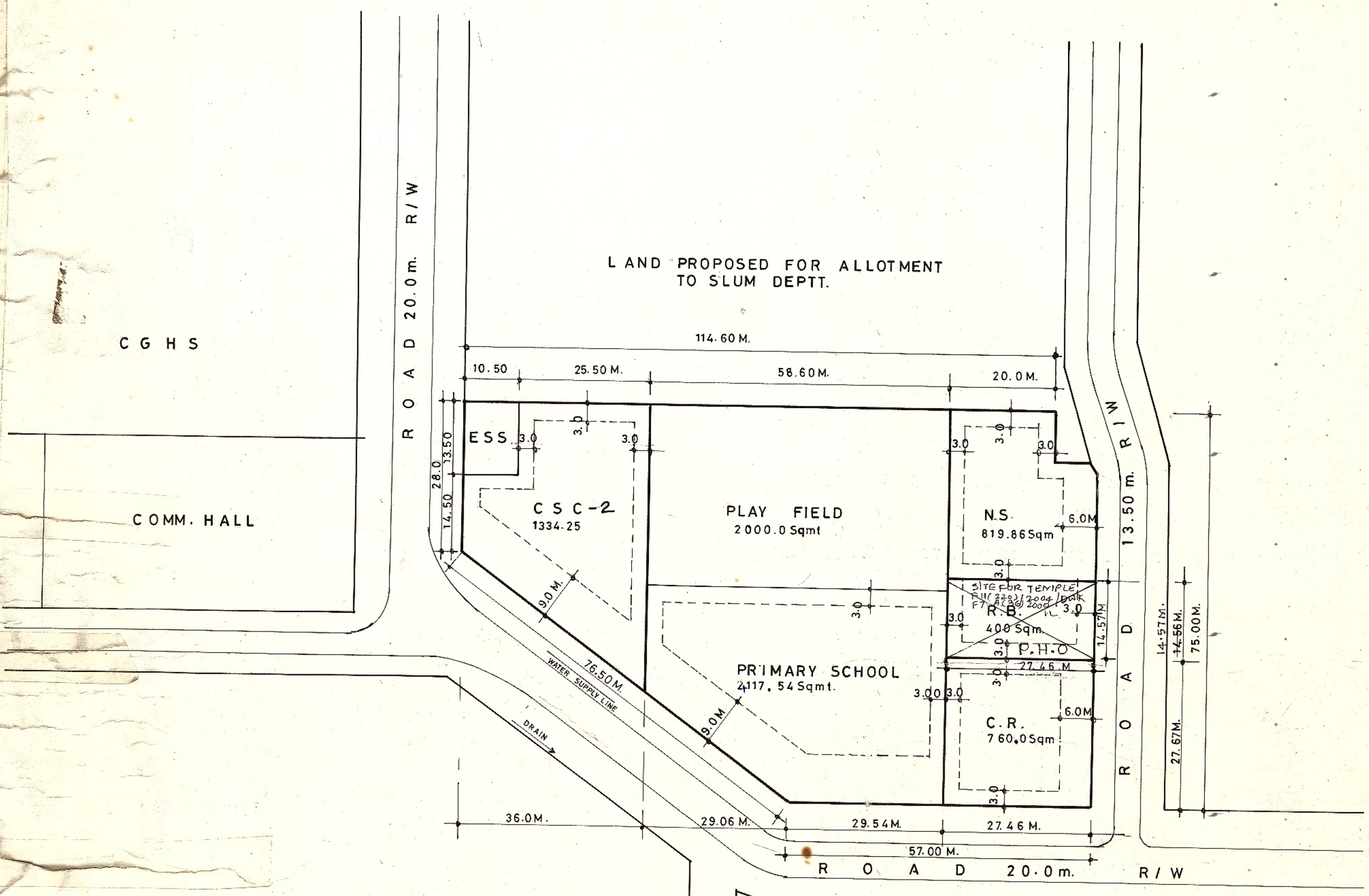

EXISTING BUILT UP

DISPENSARY

C.G.H.S

LAND PROPOSED FOR ALLOTMENT TO SLUM DEPTT.

CGHS

COMM. HALL